



## J5GxxxM2LD Gas Discharge Tube

Rev.1.0

### FEATURE

- ✧ Eliminates small size design EIA 5.5×6.0mm.
- ✧ Current handling capability 5,000A@8/20μs.
- ✧ Low capacitance and insertion loss.
- ✧ Fast response and long service life.
- ✧ Reliable to protect electrostatic surge.
- ✧ Moisture sensitivity level: Level 1.



Exterior



Schematic symbol

### APPLICATION INFORMATION

- ✧ Repeaters, modems.
- ✧ Telephone interface, line cards.
- ✧ Data communication equipment.
- ✧ Line test equipment.

### ELECTRICAL CHARACTERISTICS

Part number	DC breakdown voltage 100V/s(V)	Tolerance of $V_S$	Impulse spark-over voltage 1KV/μs(V)	Impulse discharge current 8/20μs(A)	Insulation resistance		$C_o$ (1MHz)
					GΩ	DC(V)	
J5G071M2LD	75	±20%	≤700	5000	≥1	50	≤1pF
J5G091M2LD	90	±20%	≤750	5000	≥1	50	≤1pF
J5G231M2LD	230	±20%	≤800	5000	≥1	100	≤1pF
J5G351M2LD	350	±20%	≤900	5000	≥1	100	≤1pF
J5G471M2LD	470	±20%	≤950	5000	≥1	100	≤1pF
J5G601M2LD	600	±20%	≤1300	5000	≥1	100	≤1pF

1. The parameters of all tested by ITU-T K12.
2. Total Impulse discharge current 5,000A@ 8/20μs by IEC 61000-4-5, 10 shots.
3. The capacitance is tested by 1MHz@DC=0.5V.
4. The V-T waveform of DCBV and IPBV mus lie between the shades.

**PART NUMBERING SYSTEM**

J5G 601 M 2L D  
 (1) (2) (3) (4) (5)

- (1) JieJie 5KA gas discharge tube
- (2) DC breakdown voltage, e.g., 601=60×10<sup>1</sup>=600V
- (3) Tolerance is DC breakdown voltage, M=+-20%, N=+-30%
- (4) 2-electrod DIP
- (5) Dimension in 5.5×6.0 (mm)

**PRODUCT DIMENSIONS (unit: mm)**

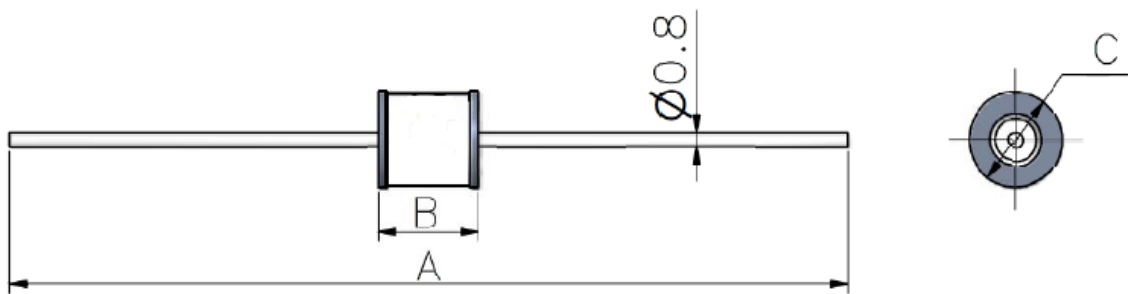

REF	mm	inch
A	62±2	2.441±0.079
B	6±0.2	0.236±0.008
C	Φ5.5±0.2	Φ0.217±0.008

REFLOW PROFILE

Reflow Condition		Pb-Free assembly (see figure at right)
Pre Heat	-Temperature Min ( $T_{s(min)}$ )	+150°C
	-Temperature Max( $T_{s(max)}$ )	+200°C
	-Time (Min to Max) (ts)	60-180 secs.
Average ramp up rate (Liquidus Temp ( $T_L$ )to peak)		3°C/sec. Max
$T_{s(max)}$ to $T_L$ - Ramp-up Rate		3°C/sec. Max
Reflow	-Temperature( $T_L$ )(Liquidus)	+217°C
	-Temperature( $t_L$ )	60-150 secs.
Peak Temp ( $T_p$ )		+260(+0/-5)°C
Time within 5°C of actual Peak Temp ( $t_p$ )		~10 secs.
Ramp-down Rate		6°C/sec. Max
Time 25°C to Peak Temp ( $T_p$ )		8 min. Max
Do not exceed		+260°C

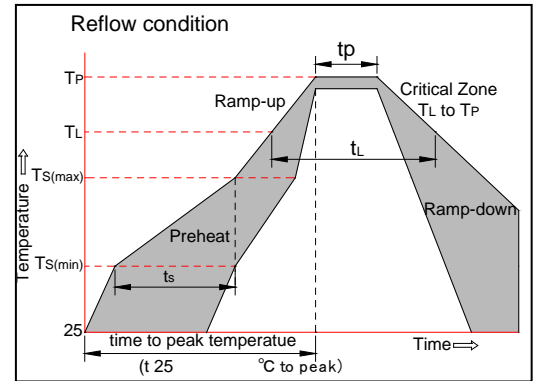

PACKAGE BOX INFORMATION

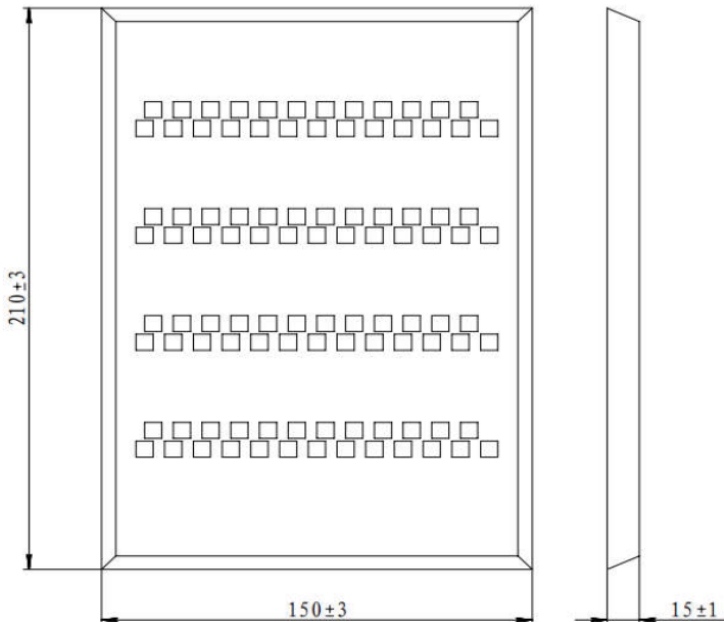

100pcs/box

**PACKAGING**

Part No.	BOX Quantity (pcs)	Per Carton (pcs)
J5GxxxM2LD	100	10,000

Information furnished in this document is believed to be accurate and reliable. However, Jiangsu JieJie Microelectronics Co.,Ltd assumes no responsibility for the consequences of use without consideration for such information nor use beyond it.

Information mentioned in this document is subject to change without notice, apart from that when an agreement is signed, Jiangsu JieJie complies with the agreement.

Products and information provided in this document have no infringement of patents. Jiangsu JieJie assumes no responsibility for any infringement of other rights of third parties which may result from the use of such products and information.

This document is the first version which is made in 21-Aug.-2017. This document supersedes and replaces all information previously supplied.

 is a registered trademark of Jiangsu JieJie Microelectronics Co.,Ltd.

Copyright©2017 Jiangsu JieJie Microelectronics Co.,Ltd. Printed All rights reserved.